

CARR TELEPHONE COMPANY

Schedule of Rates, Charges, and
Regulations Governing

Applying in the Exchanges of this Company
in Michigan as designated in the Table of
Contents herein.

LOCAL TELEPHONE EXCHANGE SERVICE

TABLE OF CONTENTS AND CHECKLIST

<u>Subject</u>	<u>Sheet No.</u>	<u>Revision</u>	<u>Issued</u>
Title Page	1	Original	03/22/93
Table of Contents	2	14th	*09/06/12
Subject Index	3	3rd	03/04/04
Application of Tariff	4	Original	03/22/93
Index of Exchanges	5	Original	03/22/93
Local Service Rates - Carr Exchange	6	5th	10/01/07
	6.0.1	Original	10/01/07
	6.0.5	1st	10/01/07
	6.1	1st	03/04/04
Exchange Area Map Sheet - Carr Exchange	7	Original	03/22/93
Application of Boundary Designations	8	Original	03/22/93
Service Charges	9	Original	03/22/93
	9.1	Original	03/22/93
	10	1st	04/23/97
	10.1	1st	04/23/97
Lifeline Service	11	6th	*09/06/12
	11.1	1st	*09/06/12
Federal Programs	12	Original	01/11/00

*New or revised sheet

Issued: September 6, 2012

September 7, 2012

Mitchel Bogner, Manager
Carr Telephone Company
4325 South Masten Road
Branch, MI 49402

RECEIVED

By Patti Witte at 4:11 pm, Oct 05, 2012

LOCAL TELEPHONE EXCHANGE SERVICE

SUBJECT INDEX

	Page		Page
Application and General Provisions	4	Index of Exchanges	5
Application of Boundary Designations	8	Lifeline Service	11-11.1
Exchange Boundary Descriptions	6	Local Exchange Area Map	7
Federal Programs	12	Local Tariff	6 - 6.1 (N)
		Service Charges	9-9.1

Issued: March 4, 2004

By: Mitchel Bogner, Manager

Branch, Michigan

LOCAL TELEPHONE EXCHANGE SERVICE

APPLICATION AND ARRANGEMENT OF TARIFF

APPLICATION

1. This Tariff applies to Local Telephone Exchange Services of the Carr Telephone Company - hereinafter referred to as the Telephone Company - in exchanges in Michigan as designated herein.
2. Local Telephone Exchange Service is that of furnishing facilities for telephone intercommunication between customers within a Local Service Area.
3. The provision of service is subject to regulations specified in the M.P.S.C. Tariffs of the Telephone Company, which tariffs as they now exist or as they may be revised, added to, or supplemented by superseding issues are hereby made a part of this Tariff.

EXPLANATION OF SYMBOLS

- (C) Signifies a changed regulation.
- (D) Signifies a discontinued rate, treatment or regulation.
- (I) Signifies an increased rate, or new treatment resulting in increased rate.
- (N) Signifies a new rate, treatment or regulation.
- (R) Signifies a reduced rate, or new treatment resulting in reduced rate.

Issued: March 22, 1993

Effective: March 22, 1993

Issued under the authority of the Michigan Public Service Commission Order dated December 22, 1992, in Case No. U-10064.

By: Mitchel Bogner, Manager

Branch, Michigan

LOCAL TELEPHONE EXCHANGE SERVICES
INDEX OF EXCHANGES SHOWING INCORPORATED
VILLAGES, TOWNSHIPS, AND COUNTIES WITHIN
ITS EXCHANGE SERVICE AREA

Exchange	Incorporated Villages	Townships	County
Carr	None	Lake Sweetwater	Lake
	None	Branch Logan	Mason
	None	Troy	Newaygo
	None	Colfax	Oceana

Issued: March 22, 1993

Effective: March 22, 1993

Issued under the authority of the Michigan Public Service Commission Order dated December 22, 1992, in Case No. U-10064.

By: Mitchel Bogner, Manager

Branch, Michigan

LOCAL TELEPHONE EXCHANGE SERVICE

Exchange: CARR

A. GENERAL

- 1. The provision of service at the rates shown below is subject to the regulations given in the General Rules and Regulations as they now exist and are filed with and form part of this Tariff.
- 2. The rates shown below entitle the customer to call all stations bearing the designation of a central office at the following exchanges, which comprise the Local Service Area:

Carr	Baldwin	Big Rapids	Fountain	Freesoil	Irons
Luther	Manistee	Reed City	Scottville	White Cloud	Hart
Hesperia	Ludington	Pentwater	Shelby	Dublin	

The Company will block 1-plus dialed calls to stations within the Local Calling Area.

- 3. The Company will treat calls made to a telephone number with an NPA NXX that is associated with the rate center that is within the customer's Local Calling Area as local calls regardless of the physical location of the called party. (N)
- 4. The Company will designated local calls as "Local VNXX Calls" if they meet all of the following criteria:
 - a. The dialed phone number is associated with a rate center included in the calling party's Local Calling Area,
 - b. The end user associated with the called number is not physically located within the rate center associated with the dialed phone number,
 - c. The rate center in which the dialed party is physically located is not within the customer's Local Calling Area,
 - d. The provider of Basic Local Exchange Service to the dialed phone number does not agree to compensate the Company for those calls per the Company's applicable access tariff based on the jurisdiction of a call to the physical location of the dialed party, and
 - e. The Company has posted numbers meeting the above four criteria on the Company's website as Local VNXX Calls.

If a customer so requests, the Company will block direct dialing to all Local VNXX Calls. (N)



Issued: October 5, 2007

Effective: January 1, 2008

Issued under the authority of Public Act 179 of 1991 as amended.

Mitchel Bogner, Manager
Carr Telephone Company
4325 South Masten Road
Branch, MI 49402

LOCAL TELEPHONE EXCHANGE SERVICE

Exchange: CARR

B. BASIC SERVICE RATES, MONTHLY RATES

1. Access Line Charge

Class of Service

Business:	
PBX	\$ 29.48
One-Party	22.77
Residence:**	
One-Party	20.97

**Existing one-party rotary residence service has been grandfathered. Existing one-party rotary residence customers will receive a \$1.50 credit for Touch-Tone Calling Service on monthly access line rates.

C. EXCHANGE SERVICE AREA - Which is that area described as follows:

Beginning at the northwest corner Section 2, T18N, R15W, Branch Township, Mason County; east to the northeast corner Section 1, T18N, R14W, Sweetwater Township, Lake County; south to the east 1/4 post Section 24, T16N, R14W, Troy Township, Newaygo County; west to the west 1/4 post Section 19, T16N, R15W, Colvax Township, Oceana County; north to the west 1/4 post Section 19, T18N, R15W, Branch Township, Mason County; west to the west 1/4 post Section 22; north to the northwest corner Section 22; east to the northeast corner Section 22; north to the point of beginning.



Issued: October 1, 2007

Effective: January 1, 2008

Issued under the authority of Public Act 179 of 1991 as amended.

Mitchel Bogner, Manager
Carr Telephone Company
4325 South Masten Road
Branch, MI 49402

LOCAL TELEPHONE EXCHANGE SERVICE

Exchange: CARR

D. LOCAL MOU RATE (C)

For calls dialed to a station bearing the designation of a central office within the Carr exchange (except for a call designated as Local VNXX Calls), the Company will charge the following:

First 2,000 Conversation MOU in each billing period \$0.00 per MOU

Each Conversation MOU over 2,000 in that billing period \$0.00 per MOU

For calls dialed to a station bearing the designation of a central office within Baldwin, Big Rapids, Fountain, Freesoil, Irons, Luther, Manistee, Reed City, Scottville, White Cloud, Hart, Hesperia, Ludington, Pentwater, Shelby or Dublin exchanges (except for a call designated as Local VNXX Calls), the Company will charge the following:

First 2,000 Conversation MOU in each billing period \$0.00 per MOU

Each Conversation MOU over 2,000 in that billing period \$0.04 per MOU

For Local VNXX Calls, the Company will charge \$0.04 per MOU plus any local termination charges (N) billed to the Company for that call. (N)

The Company will measure Conversation MOU from the time when the Company's switching equipment receives answer supervision to the earlier of when the Company's switch receives disconnection supervision from the Carr switch or from the terminating switch.

The Company will measure Conversation MOU to the next higher whole MOU per call.

The Company will not bill the end user for non-conversation time related to local calls.

Conversation MOU do not include 0-plus or 0-minus calls.

The Company will not provide call record detail for local usage.

No MOU are carried forward from month to month.

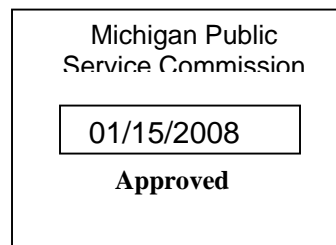

Issued: October 5, 2007

Effective: January 1, 2008

Issued under the authority of Public Act 179 of 1991 as amended.

Mitchel Bogner, Manager
Carr Telephone Company
4325 South Masten Road
Branch, MI 49402

Carr Telephone Company
M.P.S.C. No. 1(R)

1st Revised Sheet No. 6.1
Cancels Original Sheet No. 6.1

LOCAL TELEPHONE EXCHANGE SERVICE

(D)

(D)

Issued: March 4, 2004

Effective: February 16, 2004

Issued under the authority of Public Act 179 of 1991 as amended.

By: Mitchel Bogner, Manager

Branch, Michigan

LOCAL TELEPHONE EXCHANGE SERVICE
Fountain Exchange (Mich Bell) MAP SHEET (Licensed to Serve) 86°00' Irons Exchange (Mich Bell)

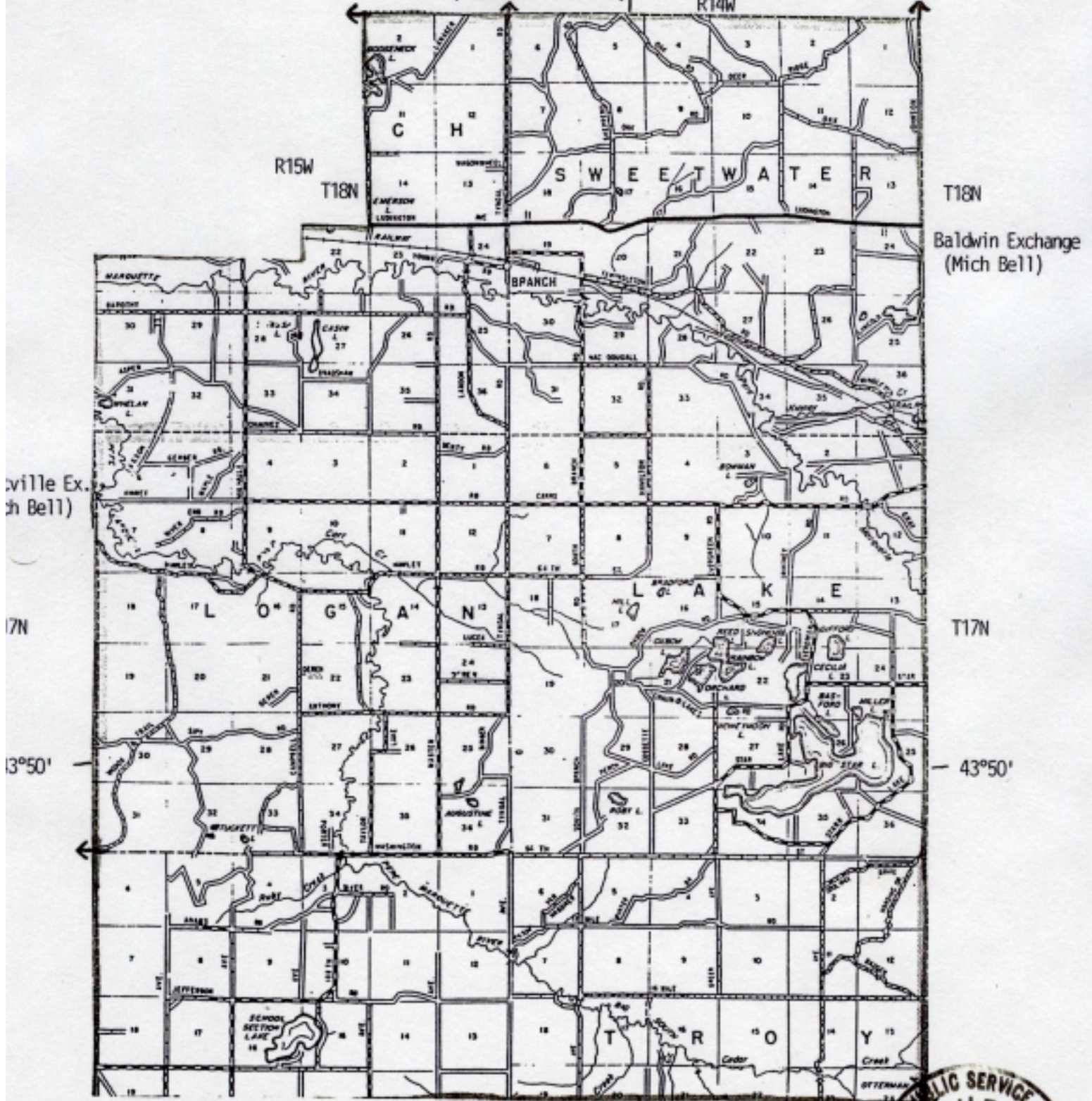

ville Ex. (Mich Bell)

T17N

3°50'

Baldwin Exchange (Mich Bell)

T17N

43°50'

Issued: March 22, 1993 Hart Exchange (GTE) 86°00' Effective: March 22, 1993

Issued under the authority of the Michigan Public Service Commission Order dated December 22, 1992, in Case No. U-10064.

By: Mitchel Bogner, Manager Branch, Michigan



TELEPHONE EXCHANGE SERVICES
BOUNDARY DESIGNATIONS

A. GENERAL

1. Application of Boundary Designations
 - a. Boundaries for the Exchange is designated on the map in Tariff M.P.S.C. No. 1.
 - b. Each establishment is within only one Exchange area except as provided in c. below.
 - c. Where the boundary is designated as a road (street or highway) the area includes that side of the highway on which are located the general plant facilities serving both sides of the highway. When such facilities are located on the near side of the highway, a customer located on the opposite side is considered to be within the area if he can be served by a drop wire using not more than one additional pole; when the general facilities are located on the far side of the boundary, a customer on that side is considered to be within the area if he can be served by means of a drop wire not requiring any additional poles.
 - d. Where the boundary is designated as the center of the road (street or highway) each side of the road is in a different service area.
 - e. Where the boundary is designated as a river (stream) or railroad each side of the river or railroad is in a different service area.
 - f. Where the boundary divides a lake the shore of the lake is in different service areas in accordance with the boundary designation at the shore line.
 - g. Where the boundary is designated as a Township Section Line or a specified distance from a Township Section Line, customers are served in accordance with their location with respect to such boundary line. When such a line is other than the section line or one-quarter or one-half mile from a section line the location of the boundary line with respect to the section line will be shown in feet or fractional miles on the Tariff Map Sheet.

Issued: March 22, 1993

Effective: March 22, 1993

Issued under the authority of the Michigan Public Service Commission Order dated December 22, 1992, in Case No. U-10064.

By: Mitchel Bogner, Manager

Branch, Michigan

LOCAL TELEPHONE EXCHANGE SERVICES

SERVICE CHARGES

A. GENERAL

1. The Service Charges covered herein are applicable in connection with the establishment of telephone service and subsequent moves, changes and additions of lines.
2. Service Charges
 - a. The Service Ordering Charge is the charge for work performed by the Telephone Company in connection with the receiving, recording and processing of customer requests for service ordered to be performed or provided at the same time, on the same system. The term "per order" means all work or service ordered at the same time for the same account.
 - b. The Line Connection Charges applied to each central office line (exchange line, trunks, etc.) for work required in the central office and outside plant, including restoral of service after temporary disconnection of service for nonpayment.
3. Customer Premises
 - a. A premises is a building, portion of a building or buildings on the same continuous property occupied by the customer in the conduct of his business or occupied by the customer as a residence. All space for offices occupied by a customer on the same or separate floors of one building are considered as a single (or same) premises.
 - (1) Same continuous property shall mean an uninterrupted plot of land within the same block and occupied by one customer. Same block is defined as parcel of land enclosed but uncrossed by public thoroughfares. Railroad tracks, rivers and alleys are not considered as public thoroughfares.
 - (2) A building shall mean a structure on one foundation or two structures on separate foundations with a common wall or abutting walls with ready access from one structure to the other by means of doorways or permanent openings through the intervening wall or walls. Structures in the same or different block occupied by one customer and connected by passageways shall be considered as the same building if the passageway is actually used as a continuation of the space in the two buildings and not principally used as a walkway.
4. Additional Conditions
 - a. Service charges are in addition to all other applicable rates and charges associated with the service being provided.
 - b. The charges specified herein do not contemplate work being performed by the Company employees at a time when overtime wages apply due to the request of the customer or do they contemplate work begun being interrupted by the customer. If the customer requests overtime labor being performed or interrupts work once begun, a charge in addition to the specified charges will be made equal to the additional cost involved.
5. Restoral of Service
 - a. Service discontinued by the Telephone Company because of non-payment when the service has not been disconnected is subject to the Restoral of Service Charge.
 - b. When service is rendered inoperative by fire or other causes beyond the control of the customer which render the premises unfit for occupancy, the same service will be reestablished at the same or different location, at the option of the customer, without Service Charge.

Issued: March 22, 1993

Effective: March 22, 1993

Issued under the authority of the Michigan Public Service Commission Order dated December 22, 1992, in Case No. U-10064.

By: Mitchel Bogner, Manager

Branch, Michigan

LOCAL TELEPHONE EXCHANGE SERVICE
SERVICE CHARGES

B. SERVICE CHARGES

1.	Service Ordering Charge		
	a.	Initial Service Order, per order	
		Applies to any new customer's service order	\$14.00
	b.	Subsequent Service Order, per order	
		Applies to any present customer's order to relocate, install, change or add to the service; telephone number change, restoral of service after disconnect for nonpayment; additional central office lines, et cetera.	7.00
2.	Line Connection Charge		
		Per Line	10.00

Issued: March 22, 1993

Effective: March 22, 1993

Issued under the authority of the Michigan Public Service Commission Order dated December 22, 1992, in Case No. U-10064.

By: Mitchel Bogner, Manager

Branch, Michigan

Carr Telephone Company
M.P.S.C. No. 1 (R)

1st Revised Sheet No. 10
Cancels Original Sheet No. 10

LOCAL TELEPHONE EXCHANGE SERVICE

(D)

Issued: April 23, 1997

Effective: April 23, 1997

(D)

Issued under the authority of the Michigan Public Service Commission Order dated
December 22, 1992, in Case No. U-10064.

By: Mitchel Bogner, Manager

Branch, Michigan

Carr Telephone Company
M.P.S.C. No. 1 (R)

1st Revised Sheet No. 10.1
Cancels Original Sheet No. 10.1

LOCAL TELEPHONE EXCHANGE SERVICE

(D)

(D)

Issued: April 23, 1997

Effective: April 23, 1997

Issued under the authority of the Michigan Public Service Commission Order dated
December 22, 1992, in Case No. U-10064.

By: Mitchel Bogner, Manager

Branch, Michigan

LOCAL TELEPHONE EXCHANGE SERVICE

LIFELINE SERVICE

A. DESCRIPTION

1. Lifeline Service applies discounts to monthly recurring rates for qualifying residential customers. These discounts are applied to existing tariffed rates and charges for residential telephone service.
2. In order to be eligible for Lifeline Service a residential customer's household income must be at or below 150% of the poverty level as determined by the United States Office of Management and Budget and as approved by the State Treasurer or the customer must participate in one of the following federal assistance program:
 - a. Medicaid
 - b. Food stamps
 - c. Supplemental security income
 - d. Federal public housing assistance
 - e. Low-income home energy assistance program
 - f. National school lunch program's free lunch program
 - g. Temporary assistance for needy families
3. Lifeline Service includes the services and functionalities enumerated in by the F.C.C. as follows: voice grade access to the public switched network; local usage; dual tone multi-frequency signaling or its functional equivalent; single-party service or its functional equivalent; access to operator services; access to interexchange service; access to directory assistance; and toll blocking for qualifying customers.
4. Other services can be provided with the Lifeline Service at applicable rates and charges.

B. REGULATIONS

1. Regulations specified elsewhere in the Company's tariffs apply to Lifeline Service.
2. Lifeline Service is available only with residence services, excluding foreign exchange service. Lifeline Service is limited to one line per household at the customer's primary residence.
3. A miscellaneous service charge does not apply when Lifeline Service is added or discontinued to existing service when that is the only work being done.
4.
 - a. A discount of 20% of the Basic Local Exchange rate or \$11.25, whichever is greater, on the monthly rate for Basic Local Exchange Service for Lifeline customers is applicable. For Lifeline customers 65 years of age or more, the discount will be 25% of the Basic Local Exchange rate or \$12.35, whichever is greater. The total discount shall not exceed 100% of all end-user common line charges plus all access recovery charges plus the Basic Local Exchange rate. (C)
 - b. The credit will be applied in the following order: (1) The Interstate End User Access Charge and Access Recovery Charge, National Exchange Carriers Association, Inc. Tariff F.C.C. No. 5, Access Service. and (2) The balance of the credit, if any, will be applied as a credit to the Basic Local Exchange rate. (C)
 - c. The Company will provide, at the qualifying customer's option, toll blocking service at no charge. The Company defines toll blocking as a service provided by the Company that lets the customer elect not to allow the completion of outgoing toll calls from their telecommunications channel. (C)
 - d. The Company will not require a service deposit in order to initiate Lifeline Service if the qualifying customer voluntarily elects toll blocking service. (C)
 - e. The Company will not disconnect Lifeline Service for non-payment of toll charges by qualifying customers.
5. The Lifeline plan will apply after receipt and processing of a completed Company or community/government provided application, including documentation indicating that the household income meets the eligibility standards established above.
6. Customers of Lifeline Service must notify the Company of any changes which would affect qualification. Reverification of eligibility will take place on an ongoing basis. When the customer is no longer eligible for Lifeline service, the Lifeline discount would be discontinued and regular tariff rates and charges would apply.

Issued: September 6, 2012

Effective: September 7, 2012

Issued under the authority of Public Acts 179 of 1991, 216 of 1995, 295 of 2000 and 235 of 2005,
and Case No. U-17019

By: Mitchel Bogner, Manager

RECEIVED

Branch, Michigan

By Patti Witte at 4:11 pm, Oct 05, 2012

LOCAL TELEPHONE EXCHANGE SERVICE
LIFELINE SERVICE

C. MONTHLY RATE FOR NON LIFELINE CUSTOMERS

A rate specified in MECA's Tariff M.P.S.C No. 25 Part XVII, Section 17.1.2.1 applies per exchange access line to cover the costs of the Lifeline service, to the Telephone Company intrastate services as listed below:

- Business and Residence exchange services excluding Lifeline customers.
- PBX Trunk Services
- Centrex Services

The rate for business Centrex station lines will be computed based on the trunk Equivalence Table specified in the Company's Tariff M.P.S.C. No. 2.

(D)

(D)

Issued: September 6, 2012

Effective: September 7, 2012

Issued under the authority Public Act 216, Case No. U-17019.

By: Mitchel Bogner, Manager

RECEIVED

Branch, Michigan

By Patti Witte at 4:11 pm, Oct 05, 2012

FEDERAL PROGRAMS

1. UNIVERSAL SERVICE SUPPORT FOR LIBRARIES AND SCHOOLS

1. In accordance with 1997 PA 95 of the Michigan Telecommunications Act, and 47 CFR 54.500 *et. seq.*, eligible elementary and secondary schools shall receive intrastate services at discounts equal to the discounts applicable for eligible interstate services if the Company receives federal universal support for such telecommunication services.
2. In accordance with 1997 PA 96 of the Michigan Telecommunications Act, and 47 CFR 54.500 *et seq.*, eligible libraries shall receive intrastate services at discounts equal to the discounts applicable for eligible interstate services if the Company receives federal universal support for such telecommunication services.
3. Eligibility for discounts shall be determined in accordance with 47 CFR 54.500 *et seq.*

2. UNIVERSAL SERVICE SUPPORT FOR HEALTH CARE PROVIDERS

1. In accordance with 47 CFR 54.601 *et. seq.*, the Company shall offer services to eligible health care providers to the extent that facilities and services are available.
2. Eligibility qualifications, provider selection, etc. shall be determined in accordance with 47 CFR 54.601 *et. seq.*
3. Services to eligible health care providers at reduced rates will be offered in accordance with 47 CFR 54.601 *et. seq.*
4. Reduced rates to eligible health care providers are available only to the extent that adequate funding is available from the federal universal support fund.

Issued: January 11, 2000

Effective: January 12, 2000

Issued under authority of 1991 PA 179 as amended.

By: Mitchel Bogner, Manager

Branch, Michigan